

Safe. Simple. Effective.

## FRONT OF HOUSE

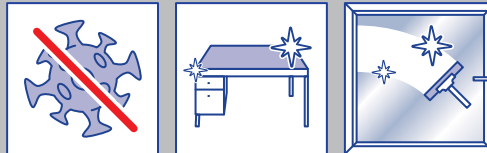

## Flash Professional F2 Disinfecting Multi-Surface Cleaner 750ml

Kills 99.99% of bacteria and  
enveloped viruses in 15 seconds\*

### KEY BENEFITS

- Cleans and disinfects in one go
- Kills 99.99% of bacteria and enveloped viruses in 15 seconds\*
- Cleans multiple surfaces, including glass and stainless steel
- Leaves high shine and no streaks behind

### PROTOCOL OF USE FOR CLEANING AND DISINFECTING

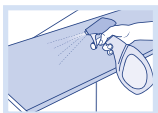

Apply product.



Leave for  
required contact  
time  
(See product  
disinfection table  
for exact contact  
times.)

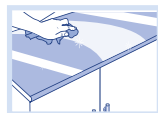

Wipe the surface  
clean.

Rinsing is not necessary, except for surfaces in contact with food.

every **experience** counts.™

P&G  
Professional

Safe. Simple. Effective.



## FRONT OF HOUSE / FLASH DISINFECTING MULTI-SURFACE CLEANER 750ML

### DISINFECTION TABLE

\* Recommend 15 seconds contact time to kill bacteria and enveloped viruses (including coronaviruses, SARS-CoV-2, and variations of SARS-CoV-2)

Efficacy	Norm	Time	Condi-tions	Strains	Concentra-tion
Bactericide	EN1276	15sec	dirty	Pseudomonas aeruginosa, Escherichia coli, Staphylococcus aureus, Enterococcus hirae	neat
	EN13697	1min	dirty	Pseudomonas aeruginosa, Escherichia coli, Staphylococcus aureus, Enterococcus hirae	neat
Fungicide	EN1650	15min	dirty	Aspergillus niger	neat
Levuricide	EN1650	5min	dirty	Candida albicans	neat
	EN13697	5min	dirty	Candida albicans	neat
Virucide	EN14476	15sec	clean	All enveloped viruses (tested on vaccinia)	neat

All testing has been conducted at external independent laboratories.

### SUSTAINABILITY

- All surfactants break down both quickly and completely into harmless material such as CO<sub>2</sub> and water.
- Recyclable bottle, non-corrosive for skin and surfaces, does not contain bleach.

### TECHNICAL DESCRIPTION

EAN code:	8001841477695
Appearance:	Clear liquid
Smell:	Pleasant (perfume)
pH (neat)	10.8
Size:	750ml

### SAFETY INSTRUCTIONS

Please make sure your employees read and understood the product label and your COSHH assessment (Chemical Risk Assessment in EU) before using this product. The label contains directions for use and both label and SDS contain hazard warnings, precautionary statements, first aid procedures and storage information. SDS are available on-line at our website [www.pgpro-msds.com](http://www.pgpro-msds.com) or can be provided to you via the call center.

### WHERE TO USE

- Effective for cleaning & disinfection of most washable interior surfaces including glass & mirrors, stainless steel/inox, work surfaces, windows and washroom surfaces, door knobs.
- Effective for cleaning greasy streaks and fingermarks on interior surfaces like tables, desks, chairs, telephones, door handles, glassware.

### WHERE NOT TO USE

- Not suitable for food areas.
- Do not use on aluminum.
- Do not use on waxed or painted surfaces.
- If in doubt, first test product on a small inconspicuous area.

every **experience** counts.™

**P&G**  
Professional™